

Endoscopic Cable Ordering Guide

Our optical fibre cables are compatible with all major scopes and illuminators.
Every light lead is high temperature xenon compatible, rated to the highest level of thermal resistance and tested to ensure the highest light output possible.



Choice of
10 colours
for easy
identification



Choice of
lengths and
sheathing
types



Free on-site light lead testing

We'll come and go
through your lead stock
to ensure your leads are
fit for use



Reinforced
for longer life

How to order

Select an option from each of the following steps to create your part number.

Step 1: Proximal

All end tips are stainless steel

ACMI

1

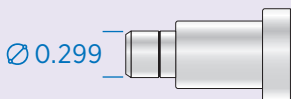

Wolf/Dyonics

2

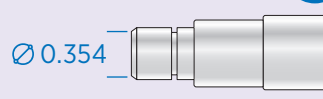

Long Wolf

L2

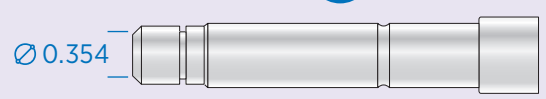

Olympus/ACMI

3

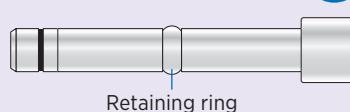

Storz

4

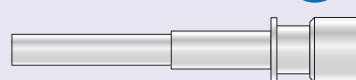

Pilling

5

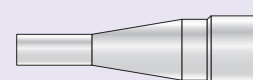

Universal

U

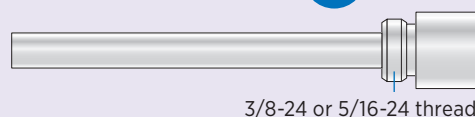

Turn over for remaining steps →

Step 2: Distal

All end tips are stainless steel

Wolf Snap On

6

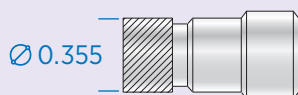

Storz

7

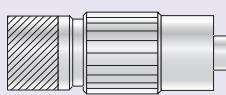

ACMI Snap-On

8

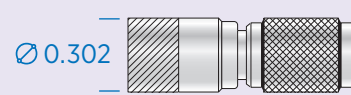

Olympus

9

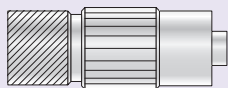

Wolf Clip-On

10



Pilling

11

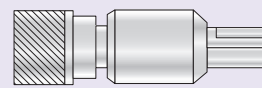

ACMI Clip-On

12

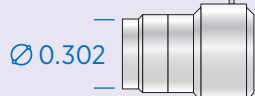

Mini Olympus

13

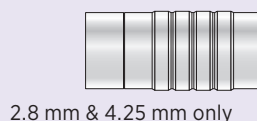

Universal

U

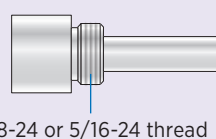

Step 3: Bundle Size

Place gauge on bundle to determine diameter

2.2mm

22

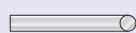

2.8mm

28

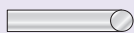

Mini Olympus only

3.0mm

30

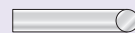

3.8mm

38

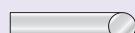

4.25mm

425

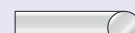

Mini Olympus only

4.8mm

48

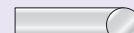

Step 4: Length

6ft

6

8ft

8

10ft

10

Call us for custom lengths

Step 5: Connector Angle

180°

180

45°

45

90°

90

Step 6: Sheathing Type

Non-reinforced

0

6" Reinforced*

6

Fully Reinforced*

FR

*Reinforced options are not available with clear sheathing

Step 7: Sheathing Colour

Black

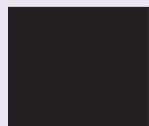

BK

Blue

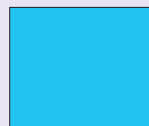

BL

Clear

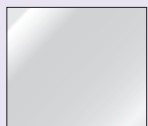

CL

Green

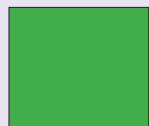

GR

Gray

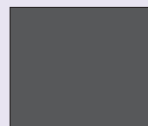

GY

Red

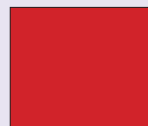

RD

Pink



PK

White

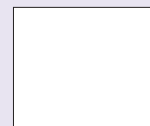

WH

4.8mm only

Yellow

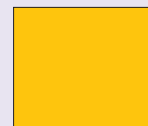

YL

Part number =

Step 1

Step 2

Step 3

Step 4

Step 5

Step 6

Step 7

Example: 474810180FRGY is a Storz Proximal, Storz Distal, 4.8mm Bundle, 254mm Length, Fully Reinforced Sheathing in Grey

Proud to be a family-run British company

E. info@surgicalholdings.co.uk T. +44 (0)1702 602050 surgicalholdings.co.uk